

NanoSpeed™ High Power 1x2 Solid-State Fiberoptic PM Switch

Product Description

The NS High Power Series 1x2 solid-state fiber optic PM switch connects optical channels by redirecting an incoming optical signal into a selected output optical fiber. This is achieved using a patented non-mechanical configuration with solid-state all-crystal design which eliminates the need for mechanical movement and organic materials. The NS high power fiberoptic PM switch is designed to meet the most demanding switching requirement of ultra-high reliability, fast response time, and continuous switching operation.

The device can be driven by a cost effective circuit with 12 V input voltage and 0-5 V control signal.

Performance Specifications

| NH Series 1x2 PM Switch | Min | Typical | Max | Unit |
|----------------------------|----------------|---------|-------|------|
| Operation Wavelength | 400 | | 1800 | nm |
| Insertion Loss | 0.4 | 0.6 | 1.0 | dB |
| IL Temperature Dependency | | 0.25 | 0.5 | dB |
| Cross Talk | 20 | 25 | 35 | dB |
| Extinction ratio | 18 | 25 | 30 | dB |
| Return Loss | 45 | 50 | 60 | dB |
| Response Time (Rise, Fall) | | | 300 | ns |
| Repetition Rate | DC | 5 | 300** | KHz |
| Operating Temperature | -5 | | 70 | °C |
| Optical Power Handling | | | 5*** | W |
| Storage Temperature | -40 | | 85 | °C |
| Fiber Type | Panda PM fiber | | | |
| Package Dimension | 65.5x23.4x6.5 | | | mm |

* Driver kit is recommended

** Special circuit

*** Continuous operation, for pulse operation call

Features

- Solid-State high speed
- Ultra-high reliability
- Low insertion loss
- Compact size
- Low cost
- Simple driver
- Low power consumption

Applications

- Optical blocking
- Light path redirecting
- Instrumentation

NanoSpeed™ High Power 1x2 Solid-State Fiberoptic PM Switch

Mechanical Dimensions (mm)

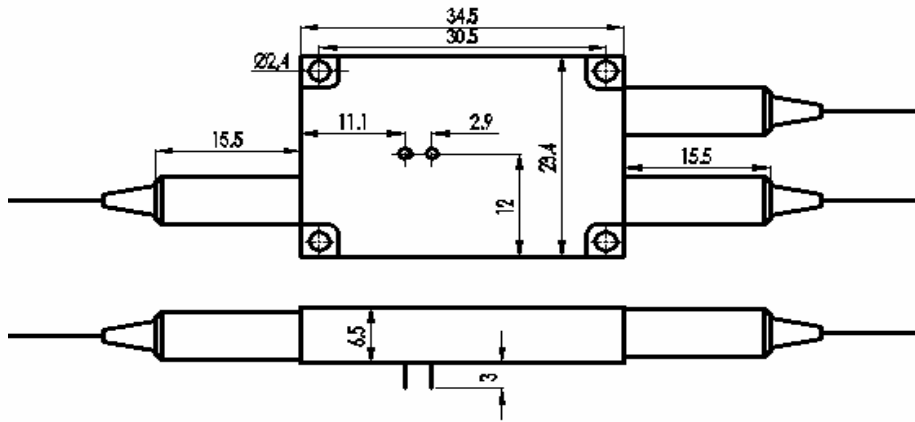

Speed and Repetition Measurement

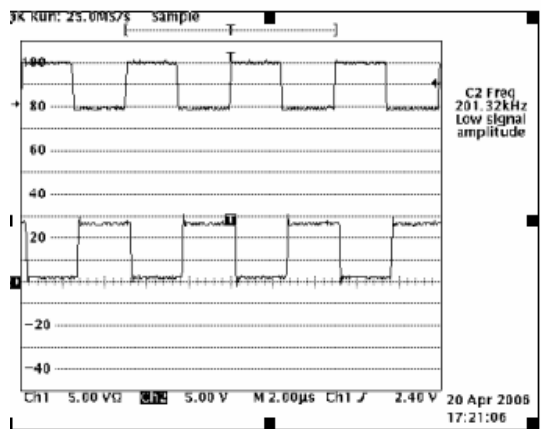
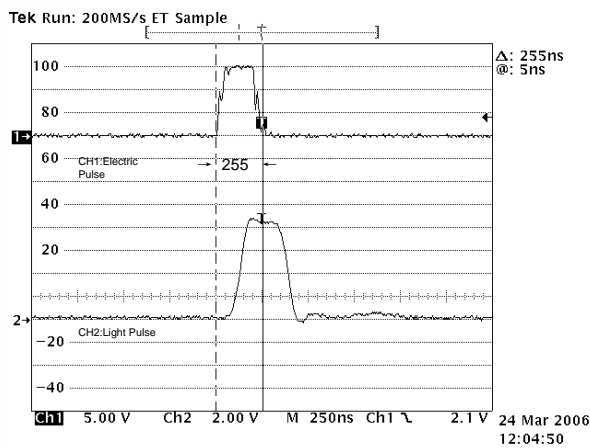

NanoSpeed™ High Power 1x2 Solid-State Fiberoptic PM Switch

Bandwidth Measurement

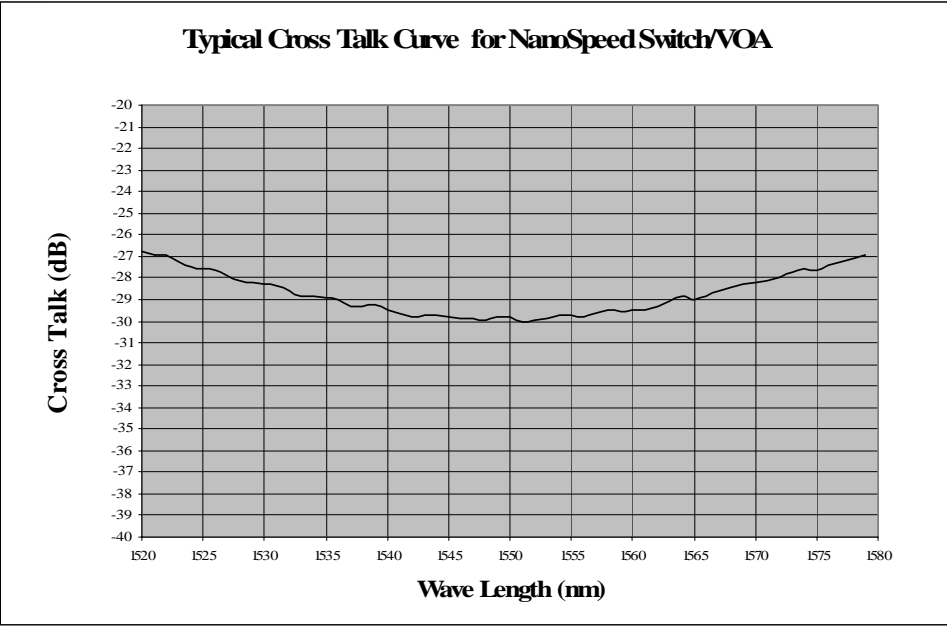

Ordering Information

| NHSW- | <input type="checkbox"/> | <input type="checkbox"/> | <input type="checkbox"/> | 1 | 1 | <input type="checkbox"/> | <input type="checkbox"/> | <input type="checkbox"/> | <input type="checkbox"/> |
|--------------|--------------------------|------------------------------------|--------------------------|----------|---|--|--|--------------------------|--------------------------|
| | Type | Wavelength | Configuration | Package | Fiber Type | Fiber Length | Connector | | |
| | 1X2=12 | 1550 =5 1310 = 3 Special = 0 | | | Panda PM fiber 400=4 Panda PM fiber 250=5 Special=0 | 0.25m= 1 0.5m = 2 1.0 m= 3 Special =0 | None = 1 FC/PC = 2 FC/APC = 3 SC/PC = 4 SC/APC = 5 ST/PC = 6 LC = 7 Special = 0 | | |