

In Line Fixed Optical Attenuator (FOA)

Features	
High precision Excellent Stability and Reliability	
Application	
Optical communication systems CATV Networks	

Specifications

Parameter		Value	
Wavelength (nm)		1310 or 1550	1310/1550
Bandwidth		±40	±40
Attenuation Tolerance (± dB)	1dB	0.3	0.3
	3dB	0.3	0.5
	5dB	0.5	0.8
	10dB	1.0	1.4
	15dB	1.5	2.0
	20dB	2.0	3.0
PDL(dB)		≤0.15	≤0.20
Return Loss (dB)		≥50	≥50
Pigtail Type		250um bare fiber	900um loose tube
Package		Φ3×54	Φ3×54
Operating temperature (°C)		-20 ~ 75	
Storage temperature (°C)		-40 ~ 85	

Package Dimensions

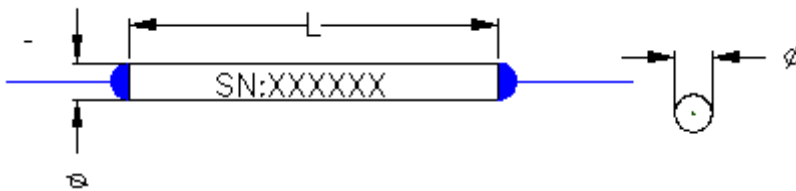

Ordering Information

FOA	Type	Wavelength	Attenuation (dB)	Pigtail Type	Fiber Type	Length	Connector	Package
	I=In Line	1310 1550 1310/1550	1=1 3=3 5=5 10=10 15=15 20=20 XX: Specify	250=250um bare fiber 900=900um loose tube 2000=2mm loose tube 3000=3mm loose tube	1=SMF-28e	1= 1m	NE=None FA=FC/APC FC=FC/UPC SA=SC/APC SC=SC/UPC LC=LC/UPC MU=MU/UPC	3x54