

# **GS-LC Series**

## **LC CONNECTOR PLUG**

### **TECHNICAL SPECIFICATIONS**



#### **Fiber Optic Products Division**

Seikoh Giken Hangzhou Co., Ltd.

526 Binkang Road Binjiang District, Hangzhou, Zhejiang,

China 310052, P.R. China

TEL:+86-571-8777-4098 / FAX:+86-571-8777-4099

QC-ZW-004-0      May   2013  
QC-ZW-004-1      Mar   2014

Copyright © 2013 by **SEIKOH GIKEN Co.,Ltd.**  
All right reserved.

The information contained herein shall not be reproduced or disclosed to any third party without the express written consent of SEIKOH GIKEN Co., Ltd.

The specifications and materials contained herein are subject to change without notice.

Please address any questions, comments, and suggestions to:

**SEIKOH GIKEN USA, Inc.**

4405 International Blvd., Suite B109  
Norcross, GA 30093 U.S.A.  
TEL: +1-770-279-6602  
FAX: +1-770-279-8839

**SEIKOH GIKEN Europe GmbH**

Siemensstrasse 9  
D-63263 Neu-Isenburg, Germany  
TEL: +49-6102-297-701  
FAX: +49-6102-297-750

**SEIKOH GIKEN Co.,Ltd.**

**Fiber Optic Products Division**

296-1, MATSUHIDAI, MATSUDO-SHI,  
CHIBA, 270-2214 JAPAN.  
TEL: +81-47-388-6111 FAX: +81-47-388-4477

## TABLE OF CONTENTS

Section	Page
1 SCOPE	1
2 PART NUMBER	1-3
3 GENERAL SPECIFICATIONS	2-4
3.1 Parts and Materials	4,5
3.2 Physical Dimensions	6
3.3 General Tolerance	6
3.4 Appearance	6
4 PACKING	6
5 IDENTIFICATION	6
6 HANDLING AND CARE	7
6.1 Conditions of Storage	7
6.2 Precautions of Use	7
6.3 Disposal	7

## 1 SCOPE

These specifications apply to the GS-LC series LC connector plug - for  $\varnothing$  2 mm cord - supplied by SEIKOH GIKEN Co., Ltd.

## 2 PART NUMBER

Part number of the connector plug is shown in Table 1.

Table 1 Part Number

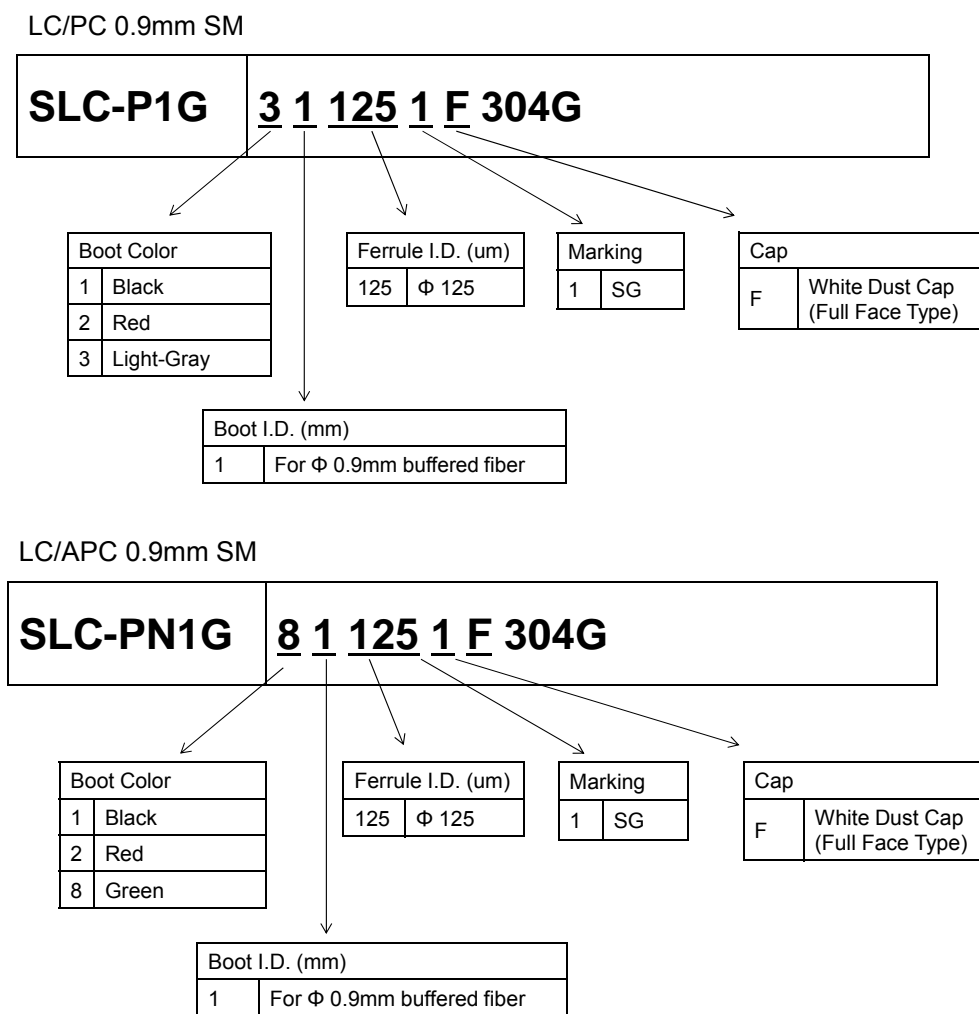

LC/PC 0.9mm MM

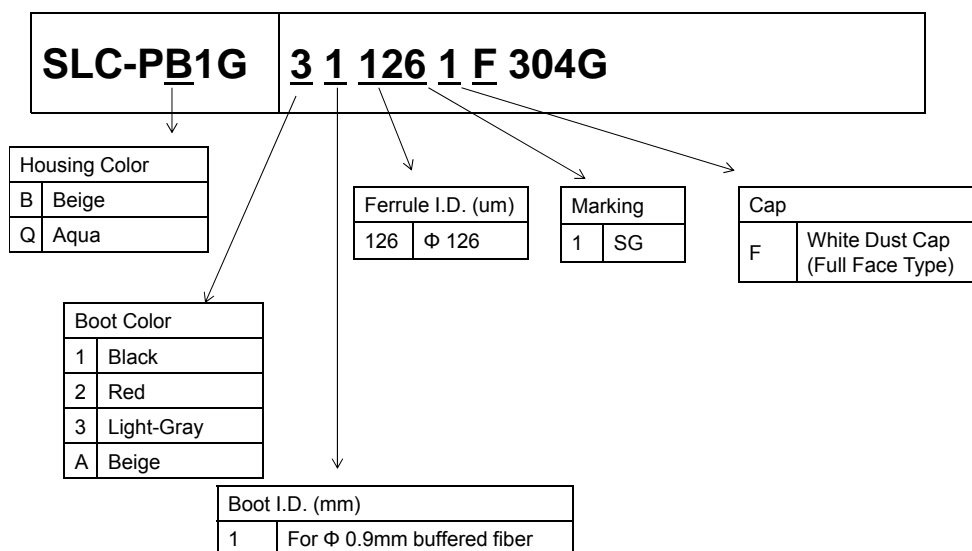

LC/PC 2mm SM

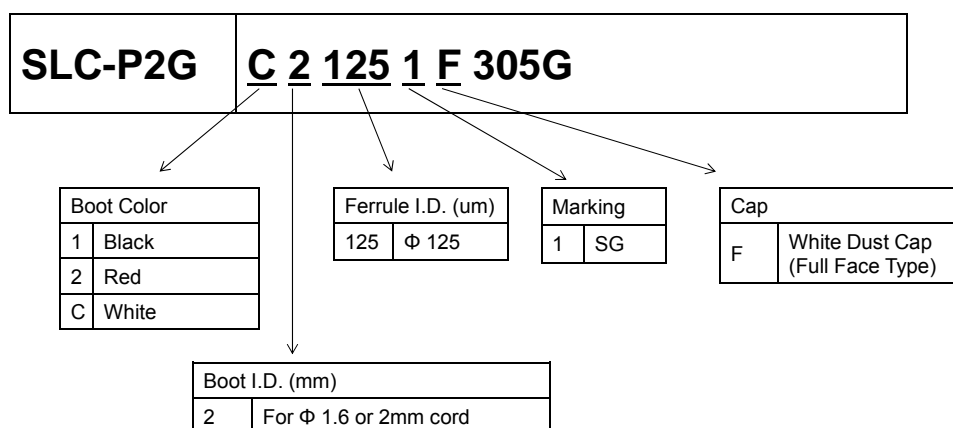

LC/APC 2mm SM

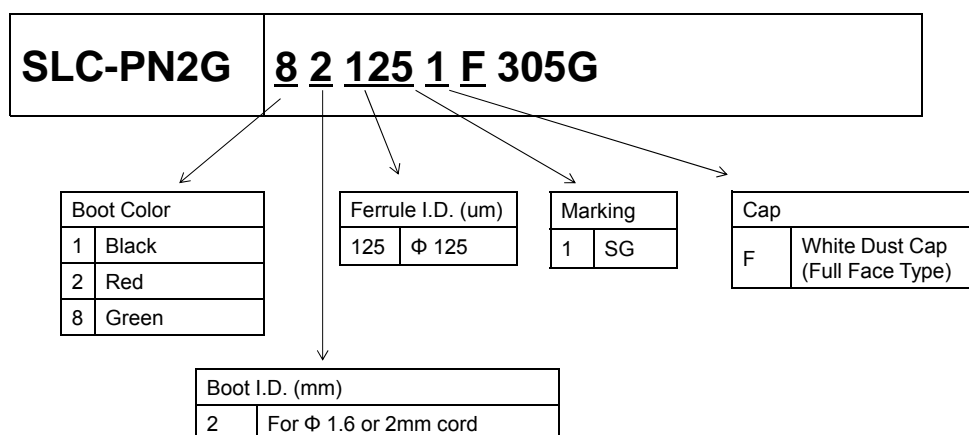

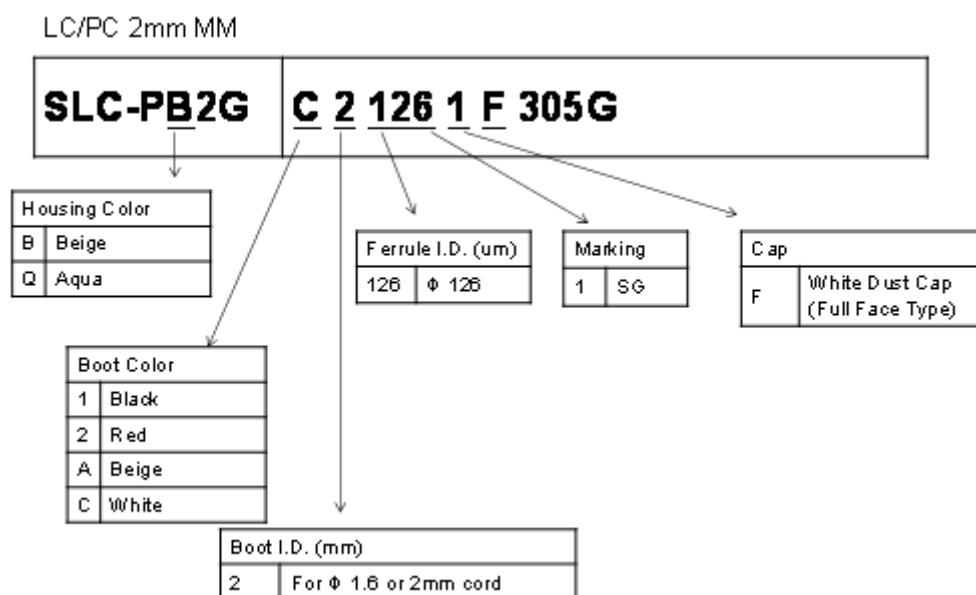

Please contact us for availability of other specifications.

### 3 GENERAL SPECIFICATIONS

#### 3.1 Parts and Materials

Parts and materials are shown in Table 2 and 3.

Table 2-1 Parts and Materials  $\phi 0.9$

Item	Part Name	Qty	Material	Notes
①	Main Body	1	See Table 2-2	See Table 2-2
②	Boot	1	TPE	Equivalent to Flammability UL94 V-0
⑨	Cap	1	PBT	Dust Cap White, Flammability UL94 V-0

Note: Item on Table 2-1 corresponds to the item reference number on Figure 1 to 4.

Table 2-2 Parts and Materials of Main Body  $\phi 0.9$

Item	Part Name	Qty	Material	Notes
③	Capillary	1	Zirconia	-
④	Flange	1	Brass	Nickel Plating
⑤	Tubing	1	PTFE	Clear, Flammability UL94 V-0
⑥	Plug Frame	1	PEI	Flammability UL94 V-0
⑦	Spring	1	Stainless Steel	-
⑧	Stopper	1	PBT-GF	Flammability UL94 V-0

Note: Item on Table 2-2 corresponds to the item reference number on Figure 2.

Table 3-1 Parts and Materials  $\phi 2$

Item	Part Name	Qty	Material	Notes
①	Main Body	1	See Table 3-2	See Table 3-2
②	Crimping Ring	1	Aluminum Alloy +Heart shrink tube	Heart shrink tube ; White Flammability VW-1
③	Boot	1	TPE	Equivalent to Flammability UL94 V-0
⑩	Cap	1	PBT	Dust Cap White, Flammability UL94 V-0

Note: Item on Table 3-1 corresponds to the item reference number on Figure 6 to 9.

Table 3-2 Parts and Materials of Main Body  $\phi 2$

Item	Part Name	Qty	Material	Notes
④	Capillary	1	Zirconia	-
⑤	Flange	1	Brass	Nickel Plating
⑥	Tubing	1	PTFE	Clear, Flammability UL94 V-0
⑦	Plug Frame	1	PEI	Flammability UL94 V-0
⑧	Spring	1	Stainless Steel	-
⑨	Stopper	1	PEI + Aluminum	Flammability UL94 V-0

Note: Item on Table 3-2 corresponds to the item reference number on Figure 6.

### 3.2 Physical Dimensions

Figure 1 shows the LC-0.9 series connector plug.

Figure 2 shows the main body.

Figure 3 to 4 show the dimensions of the parts.

Figure 5 shows the LC-2.0 series connector plug.

Figure 6 shows the main body.

Figure 7 to 9 show the dimensions of the parts.

- In accordance with IEC 61754-20 Type LC connector family.
- In accordance with JIS C 5964-20 Type LC connector family.



### 3.3 General Tolerances

Permissible deviation in dimensions without tolerance indication is in accordance with ISO 2768-m (JIS B 0405-m), as shown in Table 3.

Table 3 General Tolerance (ISO 2768-m)

Basic size step [mm]		Permissible deviation [mm]
Over	Under	
0.5	3	$\pm 0.1$
3	6	$\pm 0.1$
6	30	$\pm 0.2$
30	120	$\pm 0.3$

### 3.4 Appearance

There should be no burr, peeling of plating or scratches that affect the product.

## 4 PACKING

The product is packed to prevent damage during shipment.

## 5 IDENTIFICATION

Identification label should indicate the part number and the lot number of the product(s) and should be permanently attached to the packing bag.

## 6 HANDLING AND CARE

### 6.1 Conditions of Storage

For storage of the product, keep in the packing bag and keep away from corrosive gas, high-temperature and humidity, extreme-low temperature and direct sunlight.

### 6.2 Precautions for Use

Contamination, oil, sweat and others debris on the ferrule end face may influence the performance of the product. If contamination is on the ferrule end face, wipe the end face with the end face cleaner.

### 6.3 Disposal

When discarding this product, please follow the regulations of your own country.

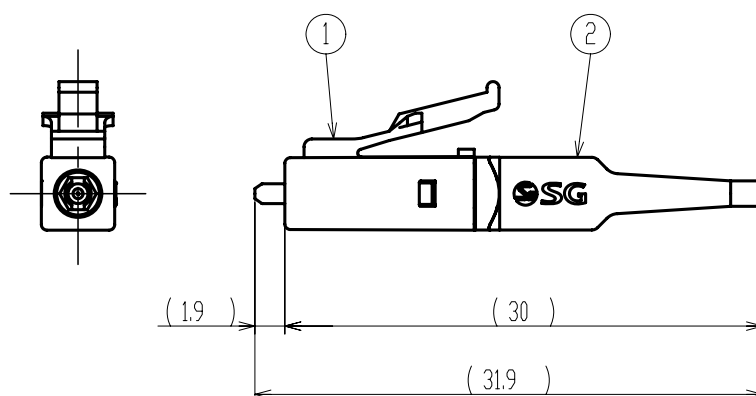

- Notes: 1 This drawing shows the tentatively assembled condition.  
On practical shipment of LC-0.9 connector plug, this tentative assembly is not available.
- 2 This drawing does not include the cap.

Unit: mm

Figure 1 LC-0.9 Series Connector Plug

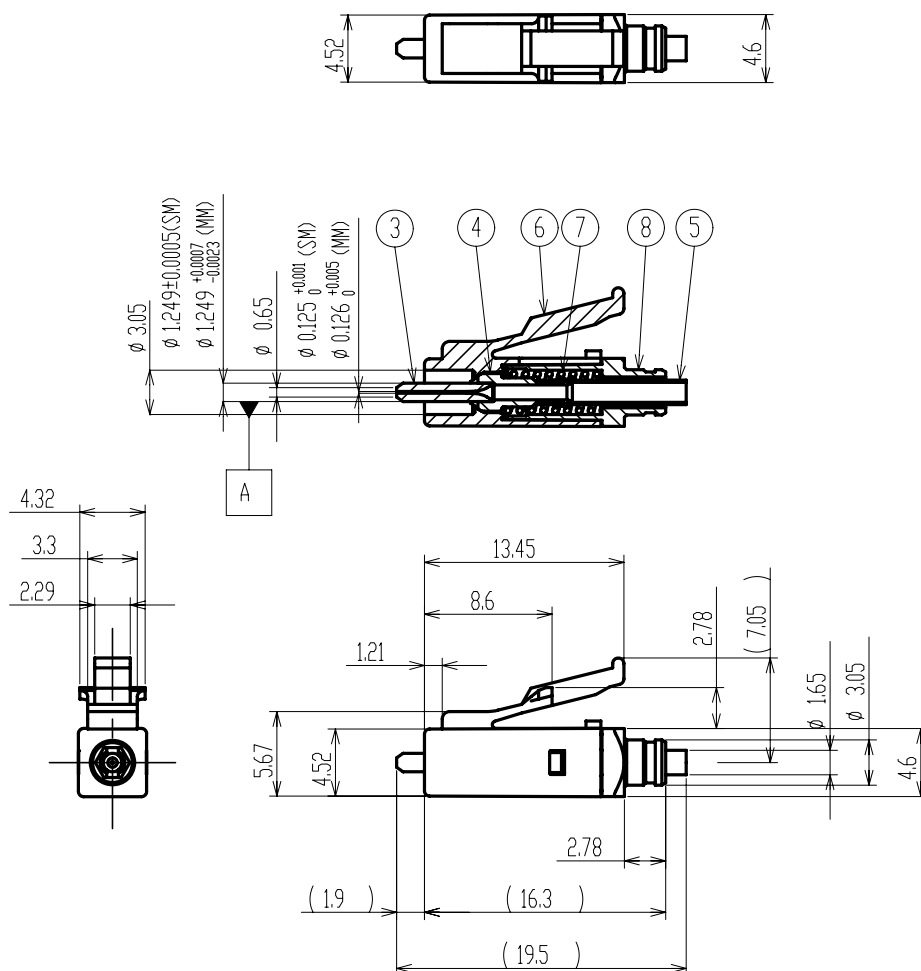

Unit: mm

Figure 2 ①Main Body

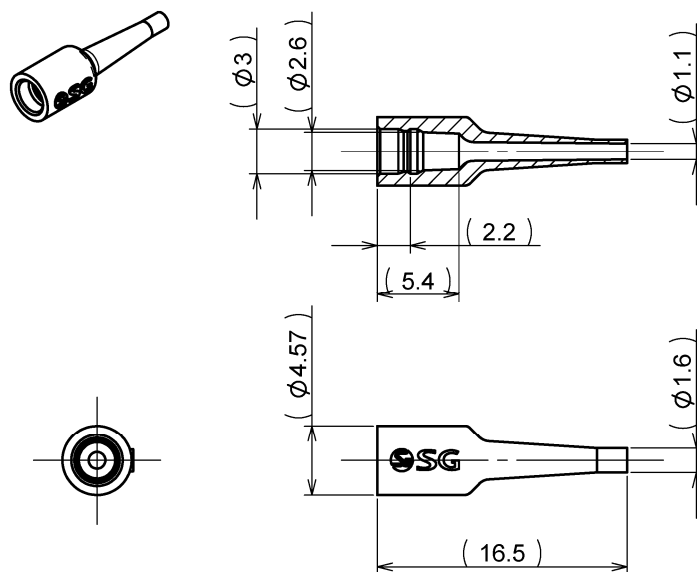

Unit: mm

Figure 3 ②Boot

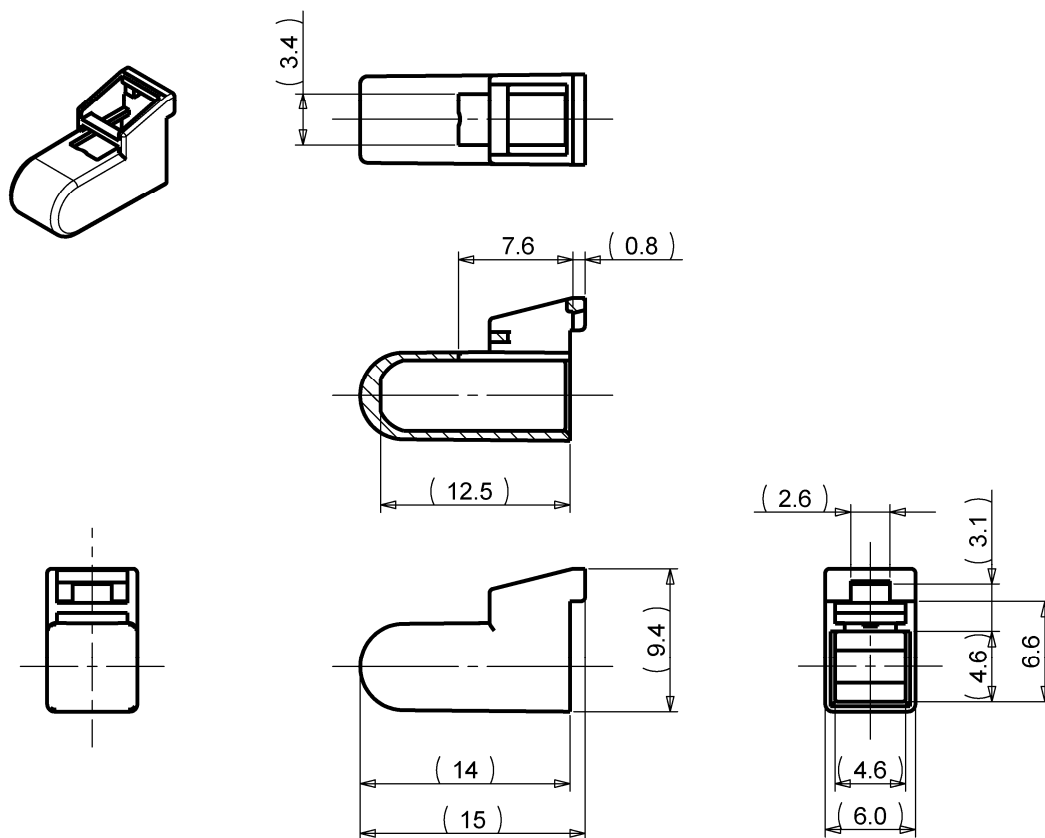

Unit: mm

Figure 4 ⑨Cap (Dust Cap)

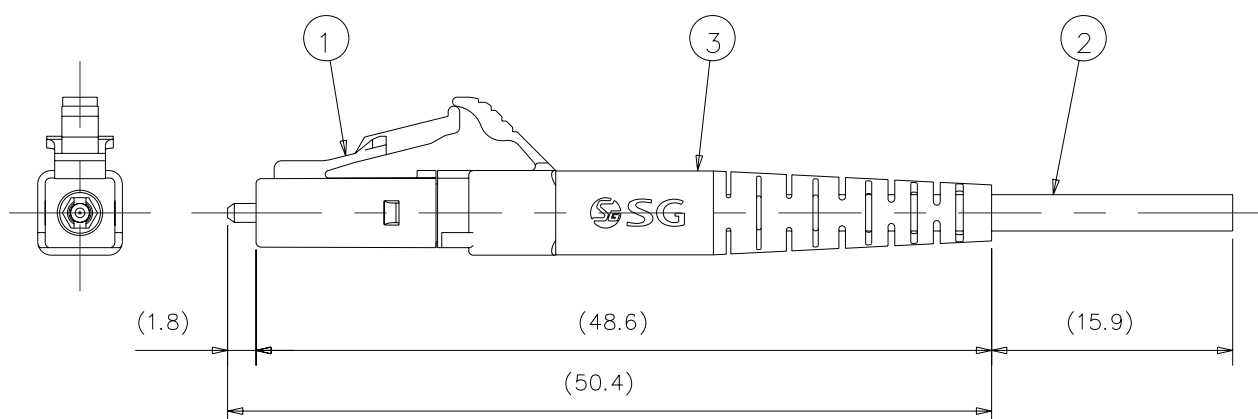

- Notes: 1 This drawing shows the tentatively assembled condition.  
On practical shipment of LC-2.0 connector plug, this tentative assembly is not available.
- 2 This drawing does not include the cap.

Unit: mm

Figure 5 LC-2.0 Series Connector Plug

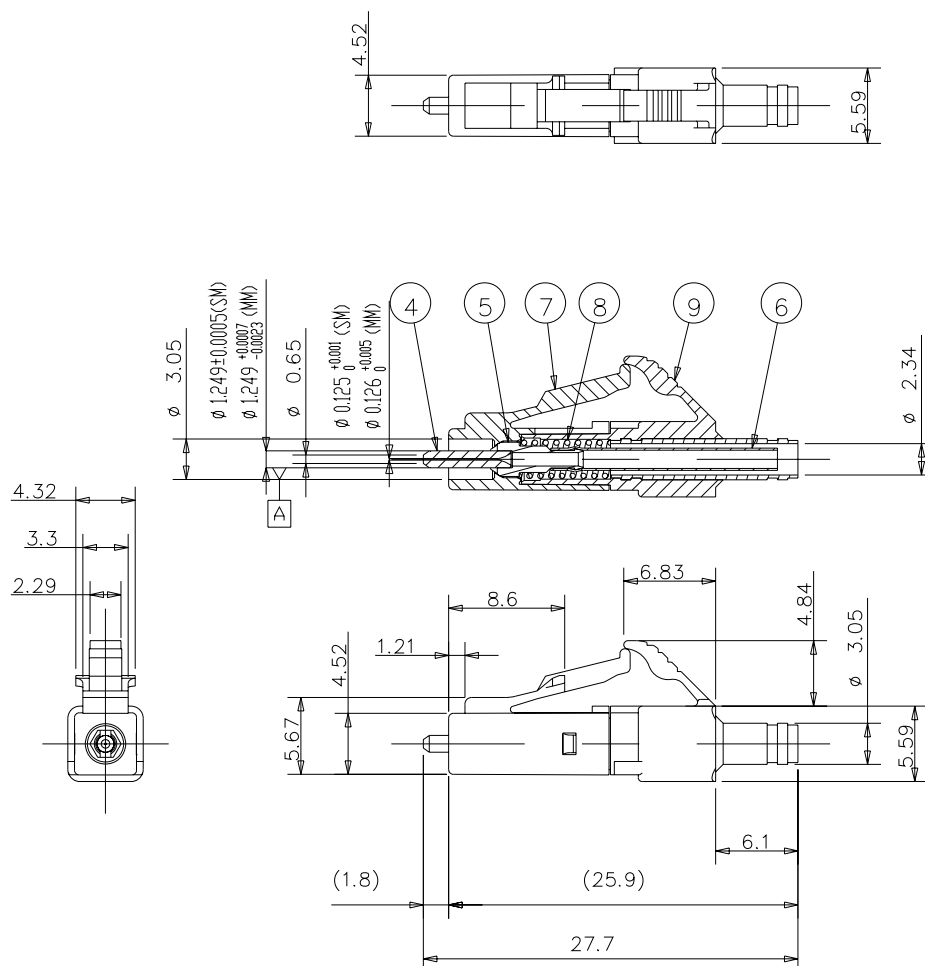

Unit: mm

Figure 6 ①Main Body

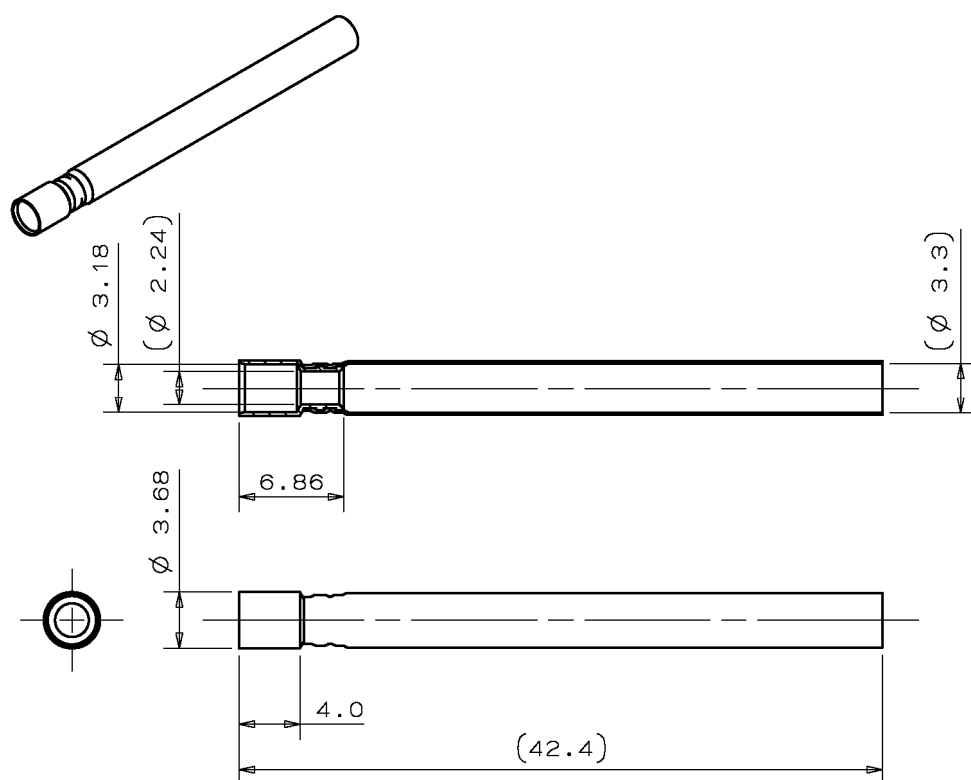

Unit: mm

Figure 7 ②Crimping Ring

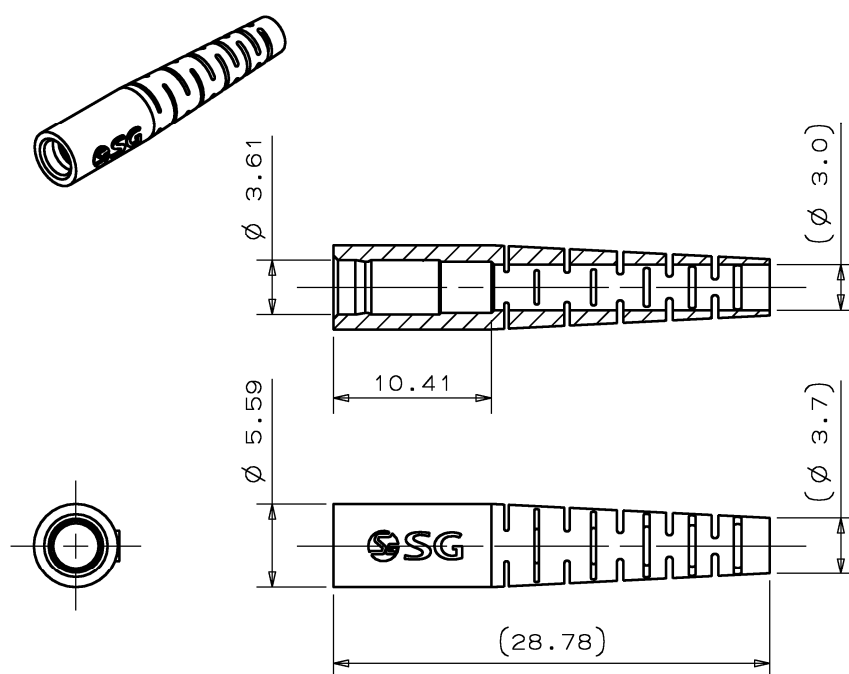

Unit: mm

Figure 8 ③Boot



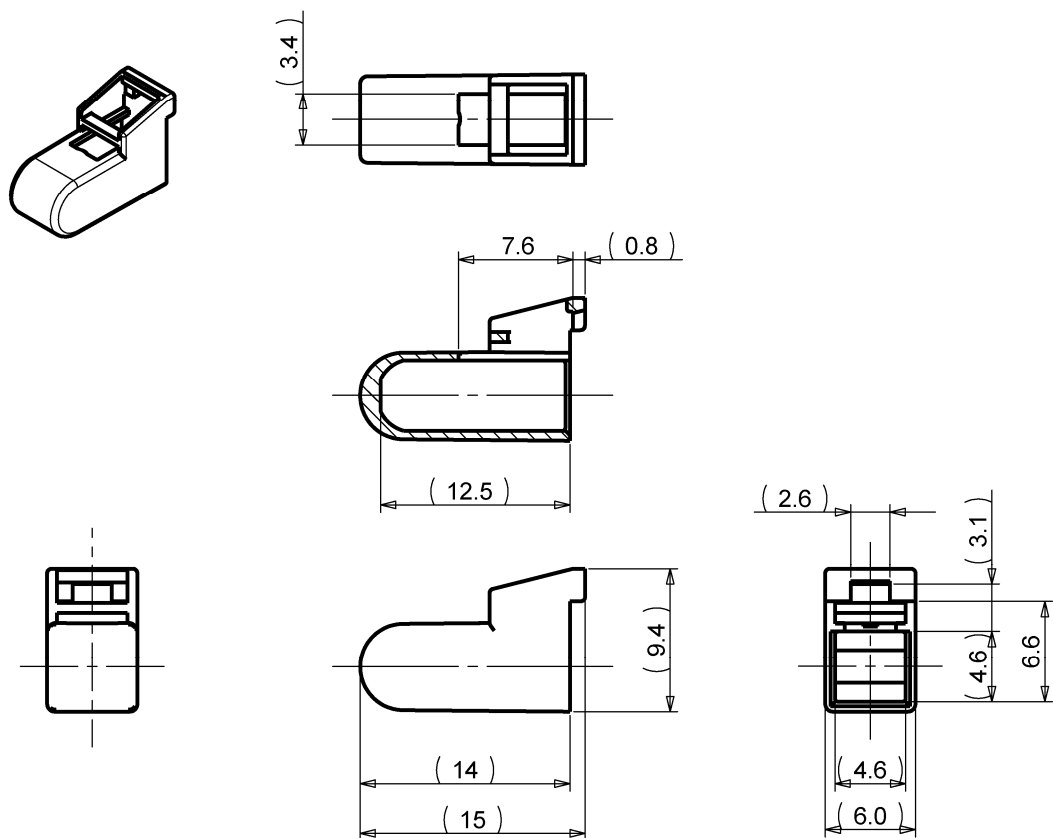

Unit: mm

Figure 9 ⑩Cap (Dust Cap)