

**976nm 10mW Fiber Receptacle Laser Diode Module| Built-in Photodiode**
**976nm~980nm 10mW Fiber Detachable LD | 9um SMF-28 Fiber**
**WSLR-980-010m-9-PD**
**Wavespectrum Laser Group**
**www.wavespectrum-laser.com**

980nm Receptacle Diode Laser		10mW		en.wavespectrum-laser.com.cn	
PARAMETER	SYMBOL	VALUE		UNIT	
Reverse Voltage	$V_r$	2.0		V	
Operating Temperature	$T_{op}$	-10~+40		°C	
Storage Temperature	$T_{stg}$	-40~+85		°C	
Lead soldering temperature (10 sec.)	$T_{is}$	260		°C	
<b>Features:</b> <ul style="list-style-type: none"> <li>976nm</li> <li>Receptacle Package</li> <li>Suit for 9um or the More</li> <li>Built-in PD</li> </ul>					
<b>Applications:</b> <ul style="list-style-type: none"> <li>Medical Laser Treatment</li> <li>Others</li> </ul>					
<b>Specifications</b>		<b>WSLR-980-010m-9-PD</b>			
		Min	Type	Max	
Center Wavelength@25°C		976nm±15nm			
Spectral Width (FWHM)	----	2.0nm		----	
Optical Fiber Output Power (After Fiber)	----	10mW		----	
Fiber Specification	9um (or more)				
	0.12 (or more)				
Recommended Operating Temperature	25°C				
Monitor Current	----	0.2mA		----	
PD Reverse Voltage	----	----		30V	
Threshold Current (Typ.)	----	15mA		30mA	
Operating Current (Typ.)	----	65mA		75mA	
Operating Voltage	----	1.7V		2.2V	
Package Style	Coaxial Receptacle or B8 Receptacle				
Ferrule Type	FC				

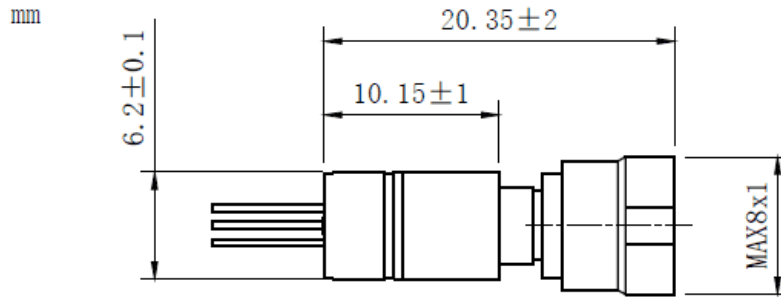
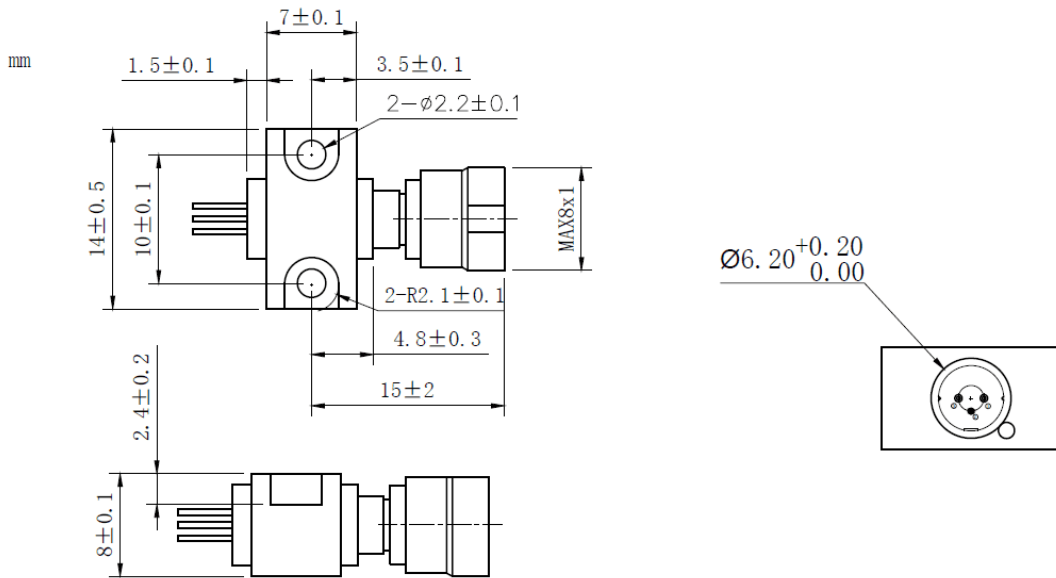
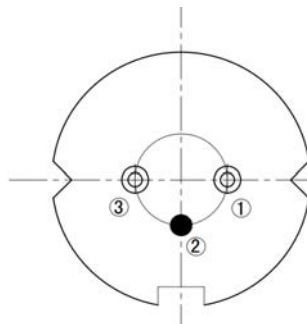

**Coaxial Receptacle Package View: (Part Number: WSLR-980-010m-9-PD)**

**B8 Receptacle Package View: (Part Number: WSLR-980-010m-9-B-PD)**

**PIN Bottom View:**

<b>PIN 1</b>	<b>LD(-)</b>
<b>PIN 2</b>	<b>LD(+)&amp;PD(-), CASE</b>
<b>PIN 3</b>	<b>PD(+)</b>



Electrically shorten LD module and store in non-extreme conditions.  
Suggest using the constant current power supply.

